

ISSUED REVISION	NO.	DESCRIPTION	BY	DATE
01	001	Initial issue	W. J.
02	002
03	003
04	004

ITEM	PART NO.	METCO. P/N	DESCRIPTION	QTY	UNIT
60	661 658 001	05-81-1280	Capitlle screw M3x0.4	2	Y
59	523 488 001	31-15-1600	Shoe base cover	1	Y
38	661 197 002	05-81-1205	M Screw M3.0x3.5 L=7mm	4	Y
57	633 908 001	42-92-1190	Shoe insert plate	1	Y
58	660 414 008	05-81-1030	M screw M4 L=8	1	Y
55	661 634 001	05-74-2000	M screw 1/4"-20x6-3/4 L=207	1	Y
54	670 030 004	45-88-2150	Spring washer steel	1	Y
53	672 059 001	45-88-2160	Washer 001.46x1.5x2.0mm	1	Y
52	611 465 001	31-17-0900	Shoe stamp	1	Y
51	641 793 001	28-06-0850	Shoe body	1	Y
50	304 665 001	44-10-0780	Shoe release lever	1	Y
48	660 024 024	05-81-1210	ST Screw M4 L=22mm	2	Y
47	671 818 002	N/A	Roller	1	Y
47	671 319 001	N/A	E-Ring	?	?
46	681 008 001	N/A	Needle bearing	1	Y
45	671 819 002	N/A	Pin Dia.0.4x11mm	1	Y
44	673 034 001	06-45-1390	Pin Dia.2.5x22mm	1	Y
43	633 907 001	N/A	Roller Bracket	1	Y
42	641 794 001	28-14-1030	Lower housing	1	Y
41	740 215 012	N/A	Motor RSS50 8520 CCW 1 For EMEA	1	Y
40	672 984 003	N/A	Motor Shoulder bolt	2	Y
39	641 792 002	N/A	Motor Housing bracket	1	Y
38	641 792 001	N/A	Motor Housing bracket	1	Y
37	680 066 004	N/A	Ball bearing D15x0.02x7	2	Y
36	611 434 001	N/A	Ball Pinion	1	Y
35	663 013 001	40-50-1830	Spring for Roller Bracket	1	Y
34	302 228 002	N/A	Connect block	1	Y
33	780 489 018	N/A	Switch (Marguard)	1	Y
32	633 652 001	40-50-1135	FR Spring Pin	1	Y
30	523 486 001	42-42-1010	Lockout Lever	1	Y
29	280 197 008	N/A	PCBA	1	Y
28	681 327 002	N/A	Ball bearing D12x0.02x6	1	Y
27	641 791 001	N/A	GC Support	1	Y
26	661 443 001	05-85-1000	T Screw M3.0x0.5 L3.5mm	6	Y
25	611 438 001	N/A	Ball gear	1	Y
24	671 608 002	N/A	Ball bearing D15x0.02x6	1	Y
23	633 264 001	N/A	Stamping on bearing	3	Y
22	681 177 003	N/A	Screw M4x0.7	1	Y
21	621 281 001	N/A	Cam Shaft	1	Y
20	692 984 001	42-24-0710	CW bushing Right	1	Y
19	633 871 001	42-28-0530	Counter Weight	2	Y
18	692 983 001	42-24-0720	CW bushing Left	1	Y
17	611 445 001	N/A	Cam with Pin	1	Y
16	692 978 001	42-40-1200	Bushing ID: 35x0.012x7	1	Y
15	692 985 001	42-24-0700	Sw Bar bushing	1	Y
14	633 869 001	N/A	Sw Bar	1	Y
13	633 870 001	42-92-1170	SS Bushing cover	1	Y
12	661 633 001	05-81-1190	M Screw M3 L=10mm	4	Y
11	660 334 002	N/A	Pin Dia.0.4x6.5mm	6	Y
10	304 672 001	N/A	Felt seal easy	1	Y
9	692 986 001	N/A	Spring Dia.0.6x6	1	Y
8	644 807 001	N/A	Plunger	1	Y
7	652 081 001	N/A	Calced Pin Dia.2.5x4.2mm	1	Y
6	611 457 001	N/A	Blade Clamp	1	Y
5	683 012 002	N/A	Tension Spring	1	Y
4	611 459 002	N/A	Blade Clamp Sleeve	1	Y
3	683 014 001	40-50-1810	Spring	1	Y
2	523 487 001	42-22-0970	Bladed Com	1	Y
1	692 200 001	50-42-5310	Building Saw Blade 10TH	1	Y

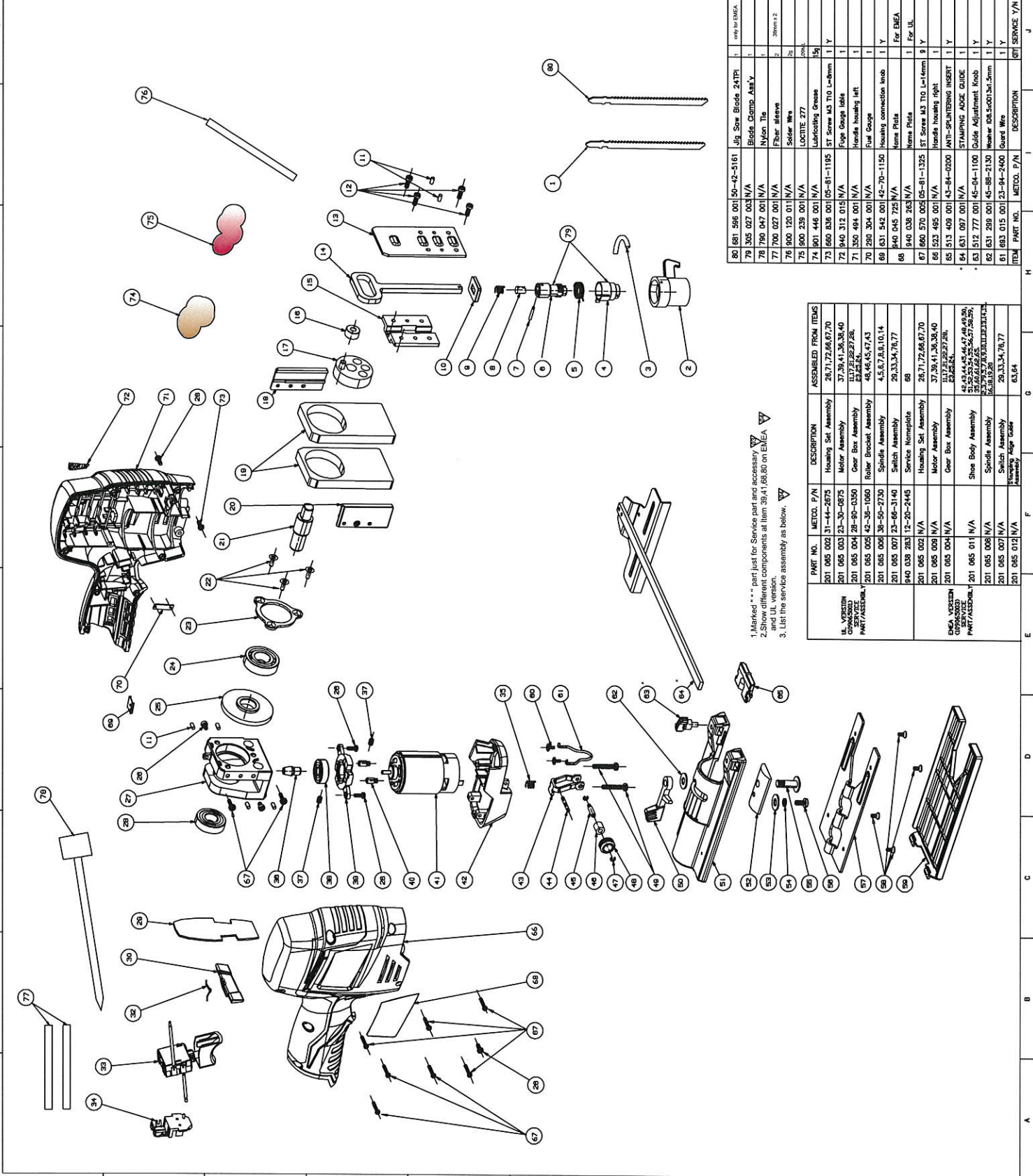

ITEM	PART NO.	METCO. P/N	DESCRIPTION	QTY	UNIT
80	681 595 001	50-42-5161	Jig Saw Blade 24TH	1	only for EMEA
79	305 027 003	N/A	Blade Clamp Ass'y	1	Y
78	790 047 001	N/A	Nylon Tie	1	Y
77	700 027 001	N/A	Fiber sleeve	2	30mm x 2
76	700 120 011	N/A	Solder Wire	20	Y
75	900 239 001	N/A	LOCITE 277	1	Y
74	801 446 001	N/A	Lubricating Grease	15	Y
73	660 238 001	05-81-1185	ST Screw M3 T10 L=8mm	1	Y
72	840 312 015	N/A	Page Gauge Idle	1	Y
71	350 494 001	N/A	Handle housing left	1	Y
70	390 304 001	N/A	Fuel Gauge	1	Y
69	631 542 001	42-70-1150	housing connection knob	1	Y
68	840 045 725	N/A	Name Plate	1	For EMEA
67	860 570 005	05-81-1325	ST Screw M3 T10 L=4mm	9	Y
66	633 485 001	N/A	Handle housing right	1	Y
65	613 408 001	43-84-0200	AWT-SPANNING INSERT	1	Y
64	632 777 001	N/A	STAMPING GUIDE	1	Y
63	612 777 001	45-04-1100	Guide Adjustment Knob	1	Y
62	631 289 001	45-88-2130	Washer Dia.5x0.7x1.5mm	1	Y
61	683 015 001	23-84-2400	Guard Wire	1	Y

UL VERSION OR SERVICE PART/ASSEMBLY	PART NO.	METCO. P/N	DESCRIPTION	ASSEMBLED FROM ITEMS
201 065 002	31-44-2875		Housing Set Assembly	28,71,72,66,67,70
201 065 003	23-30-0875		Motor Assembly	37,39,41,36,38,40
201 065 004	28-30-0350		Gear Box Assembly	13,14,15,22,27,28
201 065 005	42-35-1050		Roller Bracket Assembly	48,46,45,47,43
201 065 006	38-50-2730		Spindle Assembly	4,5,6,7,8,9,10,14
201 065 007	22-68-3140		Switch Assembly	29,33,34,78,77
201 065 008	12-20-2445		Service Spindle	68
201 065 009	N/A		Housing Set Assembly	28,71,72,66,67,70
201 065 009	N/A		Motor Assembly	37,39,41,36,38,40
201 065 004	N/A		Gear Box Assembly	13,14,15,22,27,28
201 065 011	N/A		Shoe Body Assembly	42,53,54,55,46,47,48,49,50,51,52,56,57,58,59,60,61,62,63,64,65
201 065 008	N/A		Spindle Assembly	4,5,6,7,8,9,10,14
201 065 007	N/A		Switch Assembly	29,33,34,78,77
201 065 012	N/A		Stamping Mgr case Assembly	63,64

1. Marked *** part just for Service part and accessory
 2. Show different components at item 39,41,68,80 on EMEA
 3. List the service assembly as below.